

## **Lyon Workspace Product Steel Stool Specifications**

### **Legs**

Four legs shall be not less than 1-1/16" x 1-1/16" x 14 gauge round edge formed angle, securely welded to stool seat at 3 points on each leg. A steel foot shall be arc welded at bottom of each leg. Foot shall be a minimum of 1-1/8" diameter. Legs taper out to insure against tipping. Legs punched for addition of adjustable leg extensions.

### **Stool Seat**

Shall be not less than 18 gauge, 14"x14", square formation with rounded corners, flanged down not less than 1-1/2" and welded to legs with not less than 3 welds each leg. To be perforated for ventilation.

### **Bracing**

Bracing shall consist of four 18 gauge channels securely welded into one complete frame. The complete frame shall be securely welded to the four legs with not less than four welds to each leg.

### **Finish**

Manufacturer's standard gray in powder coat finish.

### **Capacity**

Stools are rated for 350# static load with all four legs in contact with floor.

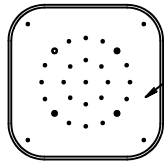

HARDBOARD SEAT:  
#9P280

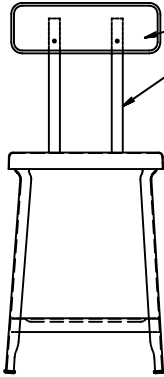

STOOL BACK:  
#97P11  
STOOL BRACE:  
#98P13

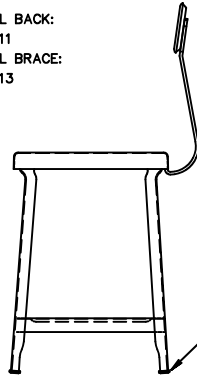

CASTER  
SOCKET:  
#9P6061

NOTE:  
ALL PARTS LISTED BELOW CAN BE USED IN ANY  
COMBINATION WITH ALL STOOLS EXCEPT AS NOTED:

- CASTER SOCKET: #9P6061
- RUBBER FOOT: #9P281
- RUBBER FOOT W/ GLIDE: #9P282
- STEEL BACK: #97P11
- BACK BRACES: #98P13
- HARDBOARD SEAT: #9P280
- ADJUSTABLE FOOT: #9P746  
(EXCEPT ON 20" & 28" STOOLS)

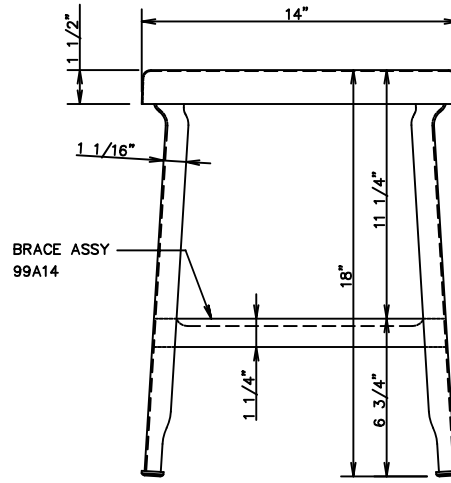

18" STOOL  
ASSY. NUMBER: 95A18

NOTE:  
HEIGHT RANGE W/ EXT.: 18 5/16"-21 5/16"

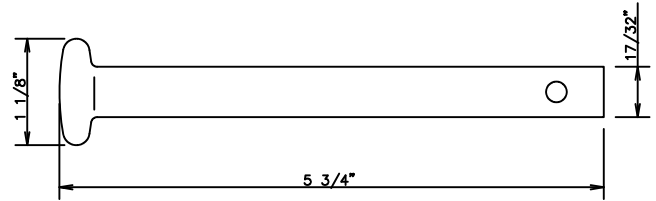

ADJUSTABLE LEG EXTENSION  
PART NUMBER: 9P746

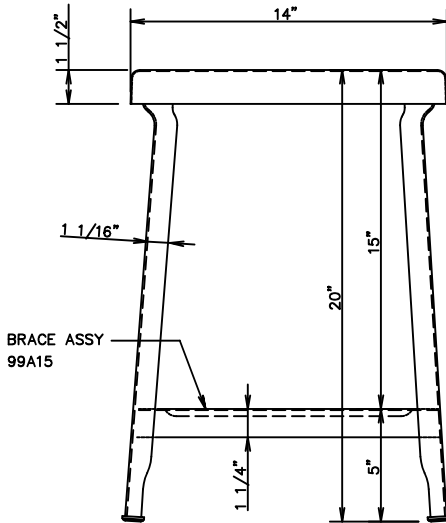

20" STOOL  
ASSY. NUMBER: 95A20

NOTE:  
BRACE ASSEMBLY COVERS TOP HOLE  
FOR ADJUSTABLE LEG EXTENSION  
HEIGHT RANGE W/ EXT.: 21 5/16"-23 5/16"

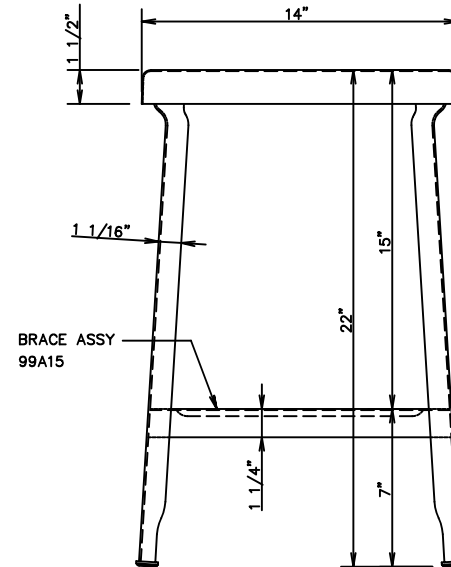

22" STOOL  
ASSY. NUMBER: 95A22

NOTE:  
HEIGHT RANGE W/ EXT.: 22 5/16"-25 5/16"

EFFECTIVE 01-06-97

| REVISED          | DATE     | FACTORY NOTE--   |
|------------------|----------|--|
| ECM# E-121698-02 | 11-13-96 | ALL SHARP BURR OR SHEARED EDGES TO BE REMOVED WHERE NOTED. |
|                  |          |  |
|                  |          |  |

ALL FORMATIONS SHOWN ARE TO BE HELD TO 01/32" ON FORMATIONS 01/64" ON HOLE CTRS. UNLESS OTHERWISE SPECIFIED.

LYON STEEL STOOLS  
GENERAL DETAILS

THIS  
DRAWING  
IN BOOK  
NUMBER  
5

| LYON METAL PRODUCTS, INC. |          |            |
|---------------------------|----------|------------|
| DATE                      | DRAWN BY | CHECKED BY |
| 11-13-96                  | LAR      |            |
| 95-1                      |          |            |

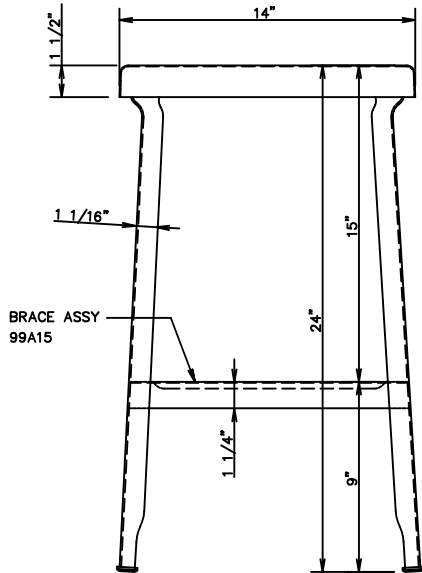

24" STOOL  
ASSY. NUMBER: 95A24

NOTE:  
HEIGHT RANGE W/ EXT.: 24 5/16"-27 5/16"

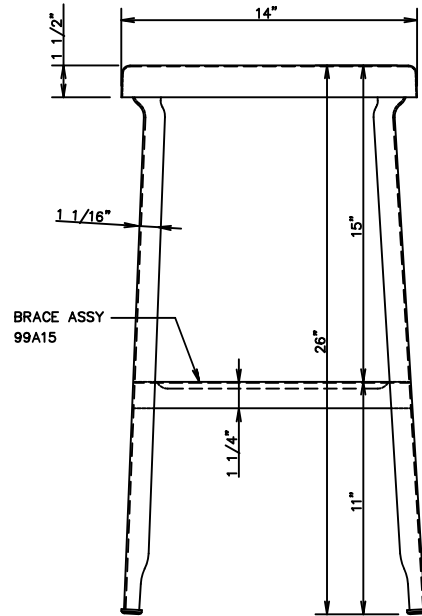

26" STOOL  
ASSY. NUMBER: 95A26

NOTE:  
HEIGHT RANGE W/ EXT.: 26 5/16"-29 5/16"

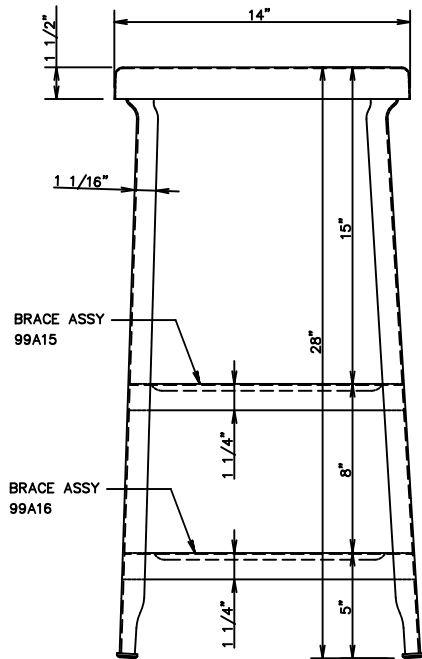

28" STOOL  
ASSY. NUMBER: 95A28

NOTE:  
BRACE ASSEMBLY COVERS TOP HOLE  
FOR ADJUSTABLE LEG EXTENSION  
HEIGHT RANGE W/ EXT.: 29 5/16"-31 5/16"

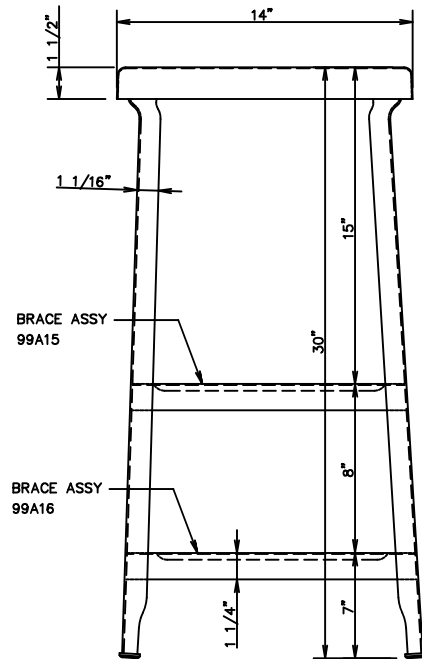

30" STOOL  
ASSY. NUMBER: 95A30

NOTE:  
HEIGHT RANGE W/ EXT.: 30 5/16"-33 5/16"

EFFECTIVE  
01-06-97

| REVISED          | DATE     |
|------------------|----------|
| ECM# E-121696-02 | 11-13-96 |
|                  |          |
|                  |          |

FACTORY NOTE--  
ALL FORMATIONS SHOWN  
ARE TO BE HELD TO 81/32"  
ON FORMATIONS 81/64"  
ON HOLE CTRS. UNLESS  
OTHERWISE SPECIFIED.

ALL SHARP BURR OR  
SHEARED EDGES TO BE  
REMOVED WHERE NOTED.

LYON STEEL STOOLS  
GENERAL DETAILS

THIS  
DRAWING  
IN BOOK  
NUMBER  
5

LYON METAL PRODUCTS, INC.  
DATE 11-13-96 DRAWN BY LAR CHECKED BY  
95-2

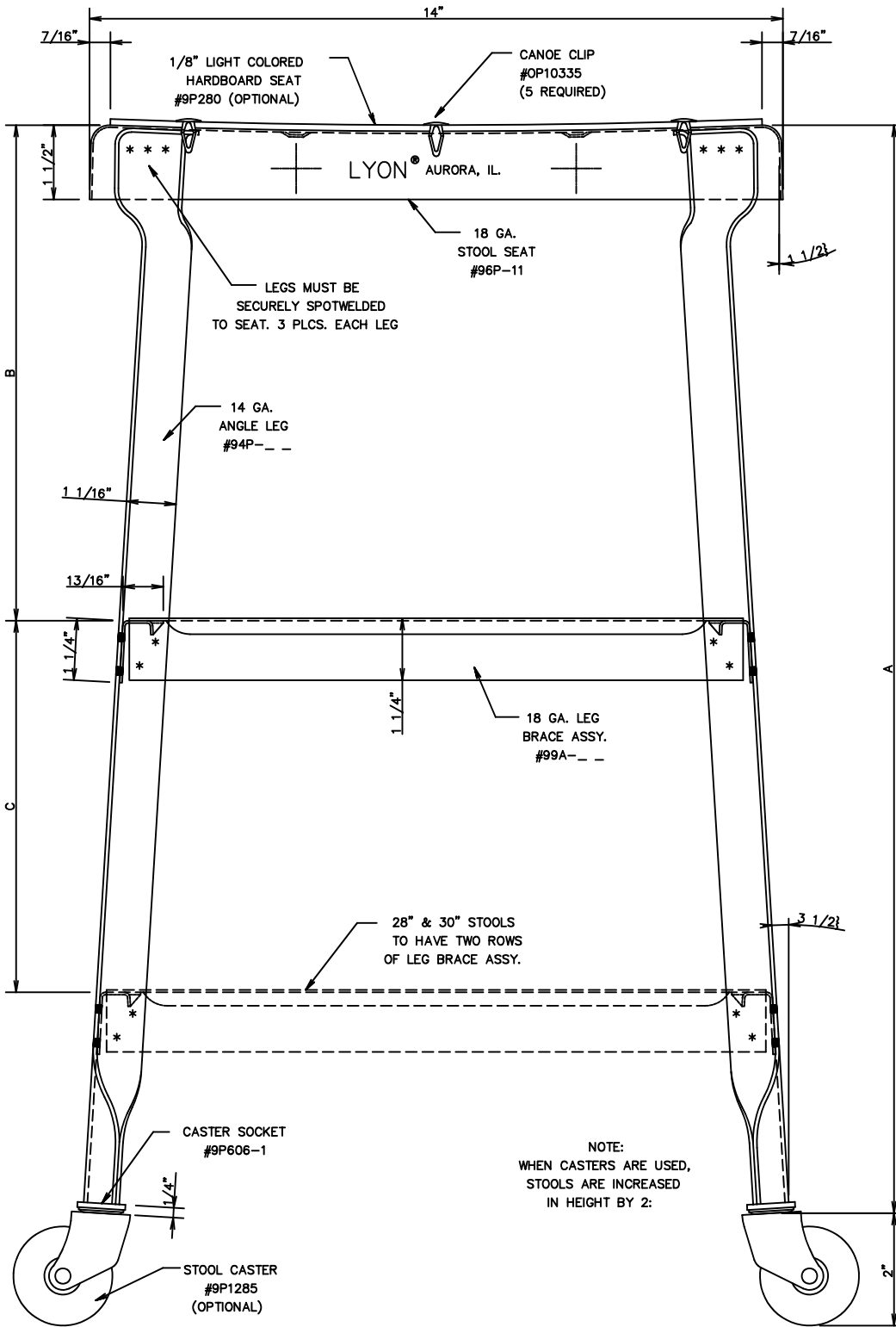

VERTICAL SECTION THRU STOOL

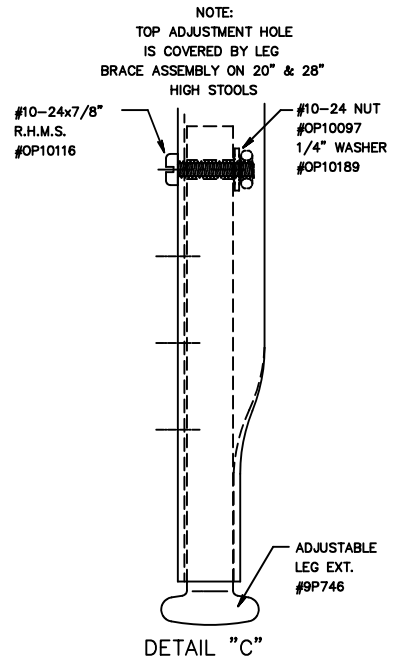
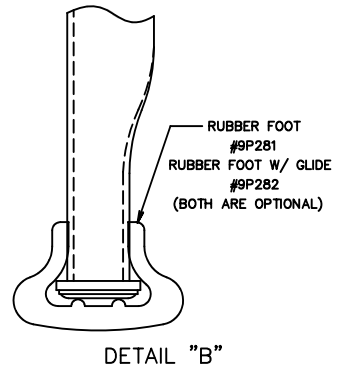
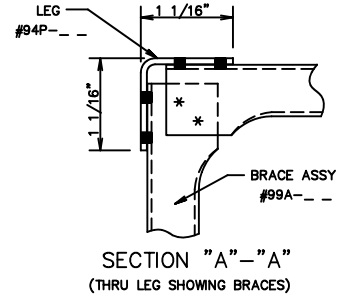

| HEIGHT | B       | C   | STOOL # |
|--------|---------|-----|---------|
| A      | 11 1/4" | --- | 95-A18  |
| 18"    | 15"     | --- | 95-A20  |
| 20"    | 15"     | --- | 95-A22  |
| 22"    | 15"     | --- | 95-A24  |
| 24"    | 15"     | --- | 95-A26  |
| 26"    | 15"     | 8"  | 95-A28  |
| 28"    | 15"     | 8"  | 95-A30  |
| 30"    | 15"     | 8"  | 95-A30  |

EFFECTIVE 01-06-97

| REVISED          | DATE     | FACTORY NOTE--   |
|------------------|----------|--|
| EON# E-121606-02 | 11-13-96 | ALL FORMATIONS SHOWN ARE TO BE HELD TO 81/32" ON FORMATIONS 81/64" ON HOLE CTRS. UNLESS OTHERWISE SPECIFIED. |
|                  |          | ALL SHARP BURR OR SHEARED EDGES TO BE REMOVED WHERE NOTED.   |

LYON STEEL STOOLS  
GENERAL DETAILS

THIS DRAWING IN BOOK NUMBER  
**5**

LYON METAL PRODUCTS, INC.  
DATE 11-13-96  
DRAWN BY LAR  
CHECKED BY  
**95-4**

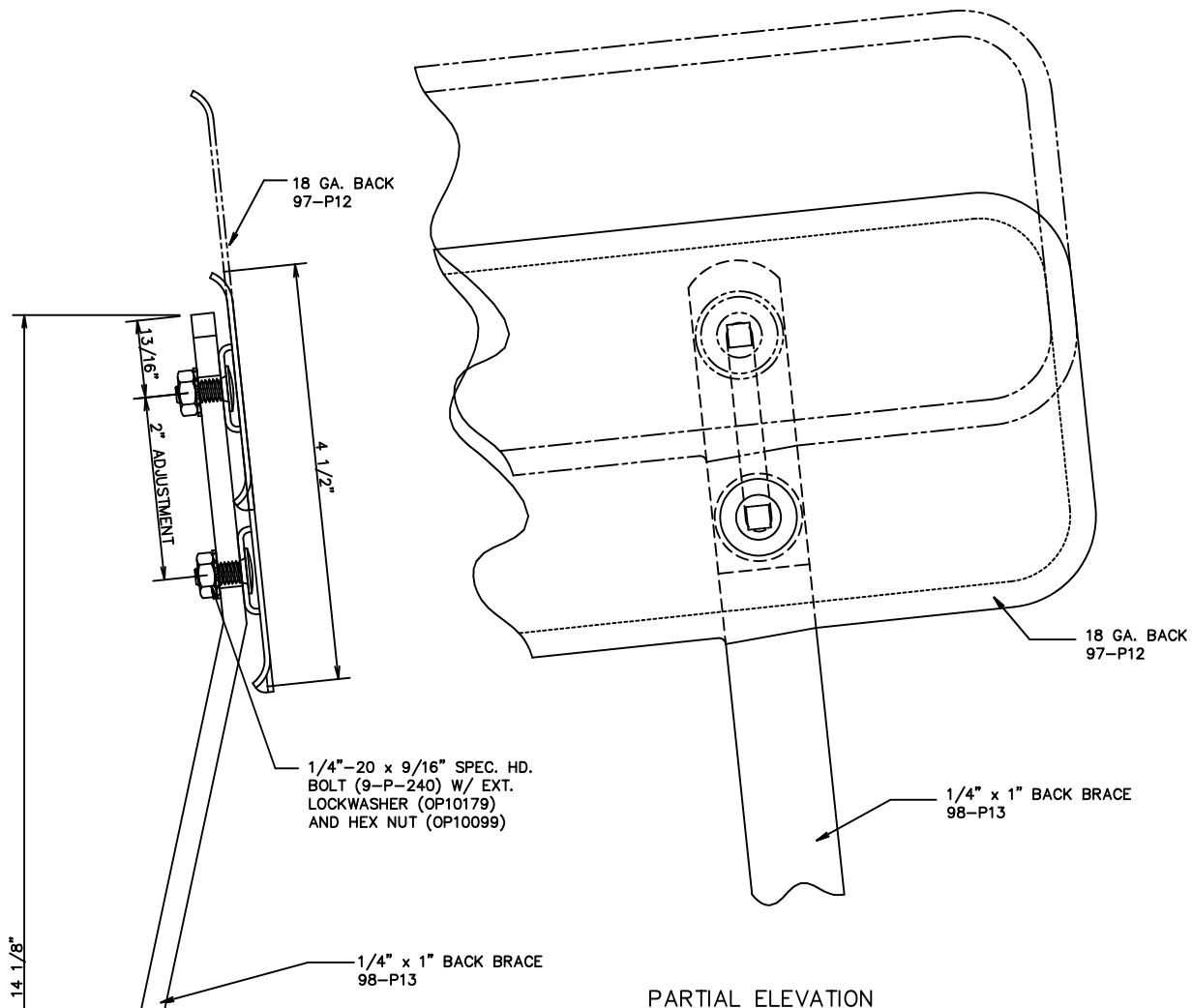

PARTIAL ELEVATION

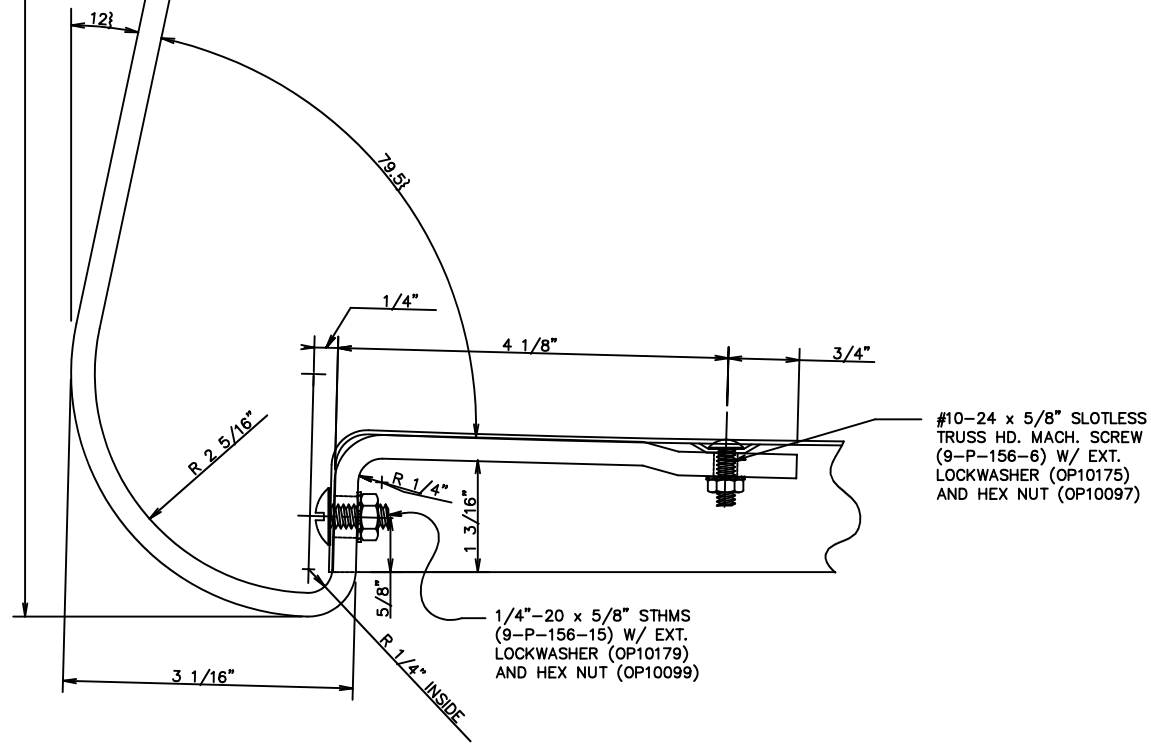

VERTICAL SECTION THRU STOOL BACK

EFFECTIVE: 01-06-97

| REVISED          | DATE     | FACTORY NOTE--   |
|------------------|----------|--|
| ECM# E-121606-02 | 12-18-96 | ALL SHARP BURR OR SHEARED EDGES TO BE REMOVED WHERE NOTED.   |
|                  |          | ALL FORMATIONS SHOWN ARE TO BE HELD TO 01/32" ON FORMATIONS 01/64" ON HOLE CTRS. UNLESS OTHERWISE SPECIFIED. |

LYON STEEL STOOLS  
GENERAL DETAILS

THIS DRAWING IN BOOK NUMBER  
**5**

| LYON METAL PRODUCTS, INC. |          |            |
|---------------------------|----------|------------|
| DATE                      | DRAWN BY | CHECKED BY |
| 12-18-96                  | DB       |            |
| <b>95-5</b>               |          |            |