



OWNER'S MANUAL  
**LYON**<sup>®</sup>  
 INDUSTRIAL STOOL  
 MODEL NO. 2022N

Save This Manual For  
 Future Reference

**DESCRIPTION**

Lyon Industrial Stool is ergonomically engineered for durability, support, comfort and long wear in tough environments. Pneumatic lift allows 8" of adjustment while you are seated and an additional 10" of manual adjustment by repositioning the lift. Five-leg base is one-piece construction of welded steel tube, for stability at high height ranges. Five high-impact, non-marking, oil-resistant glides withstand harsh environments. Casters are available as an option.

**GENERAL SAFETY INSTRUCTIONS**

Do not stand on seat. Stool must be on level surface to ensure proper stability. Only use stool when fully assembled. Periodically check fasteners and tighten securely as needed. Never use stool if it does not perform according to this manual. Warranty may be void if stool is used while damaged. Immediately call and report any problems (see How to Order Repair Parts) and always give the serial number from label under base.

**CAUTION:** Allow for optimum support. Never position lift higher than the bottom of the base tube. Always leave at least 1/2" clearance between the bottom of the lift and the floor.

**ASSEMBLY**

1. Unpack stool. Check all parts against parts list before beginning assembly. Allow parts to warm to room temperature prior to assembly.
2. Turn base upside down. Place glide onto base leg and tap glide down (Key Nos. 1 and 2) using a rubber mallet. Glides should fit snug. Glides are easier to install if they are slightly expanded. Use blow dryer or warm water (dry thoroughly) to expand glides. Be sure glide is inserted fully onto leg to ensure stability of base. Repeat for other four glides. Turn base right side up.

3. Slide pneumatic lift (Key No. 6) into base (loosen base knob if necessary) with pneumatic lift piston pointed away from legs. Insert stop ring (Key No. 5) into groove in end of pneumatic lift. To install stop ring, gently peel one end of stop ring away from rest of coil. Place end in groove on pneumatic lift. Slide fingers along coil, guiding strip into groove, until stop ring is fully installed.
4. Position pneumatic lift about half way down in base. Tighten base knob (Key No. 3) to secure pneumatic lift.
5. Align hole in bottom of seat (Key No. 8) with top of lift. Push down on seat to insert firmly together. Underneath the right side of seat is a handle (Key No. 7) to adjust height of lift.

**MAINTENANCE**

The pneumatic lift is permanently lubricated at the factory and needs no further lubrication. **Never lubricate the pneumatic lift.** This could damage the lift and void your warranty.

Do not remove clip from bottom of lift. Call for immediate assistance if clip is missing or damaged. Clean polyurethane seat and backrest with soap and water. To repair cuts, apply a few drops of quick drying glue in the cut and press the sides together until glue sets.

**HOW TO ORDER REPAIR PARTS**

When ordering repair parts or reporting problems, always give the following information:

<b>NAME OF ITEM</b>	<b>MODEL NUMBER</b>
Industrial Stool	2022N
<b>PART DESCRIPTION</b>	<b>PART NUMBER</b>

All parts listed may be ordered from your local Lyon Dealer or Lyon Workspace Products, P. O. Box 671, Aurora, IL 60507  
 800/323-0082 or 630/892-8941

**WARRANTY**

Lyon Workspace Products warrants all of its products to be free from manufacturing defects for the life of the product when it is used in accordance with manufacturer's specifications and/or operating instructions. The life of the product is ten years of single shift users, five years for two shift users, and two-and-a-half years for three shift users, for users not weighing more than 250 pounds. During this period Lyon Workspace Products will repair or replace, at its option, any part found upon examination to be defective. Freight, labor or service charges for removal of defective parts and installation of replacement parts are not included. **All parts that are replaced due to wear, misuse or abuse are not covered by the warranty but replacement parts can be purchased from Lyon Workspace Products.**

This warranty applies to the original purchaser, and the purchaser's sole remedy under this warranty is limited to replacement or repair of the product and specifically excludes consequential, incidental or any other damages directly or indirectly resulting from a failure or loss of use of or by Lyon Workspace Products.

To obtain warranty service, a return authorization by Lyon Workspace Products must accompany all returned merchandise. **Contact your Lyon Dealer or Lyon Workspace Products, P.O. Box 671, Aurora, IL 60507, 800/323-0082 or 630/892-8941.**

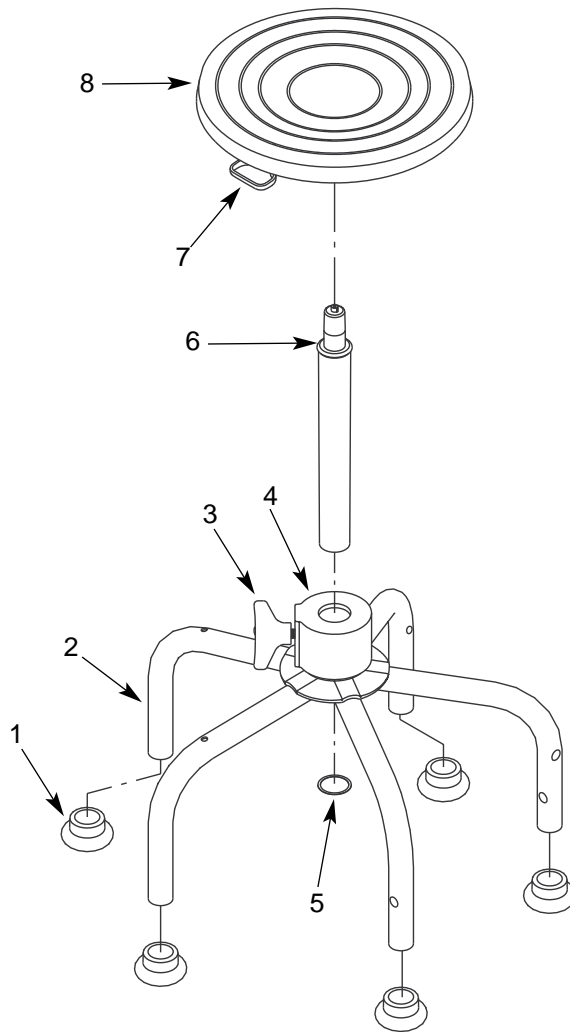

KEY NO.	DESCRIPTION	QTY	PART NO.
1	Glide	5	09019.00
2	Base	1	01254.03
3	Base Knob	1	01750.15
4	Base Cover	1	10202.00
5	Stop Ring	1	01754.00
6	Pneumatic Lift	1	01753.50
7	Handle	1	03374.00
8	Seat with Handle	1	03429.06

OPTIONAL ACCESSORIES	
Top Footrest Assembly	2081N
Straight Footrest	2082N
Caster with Insert	2061N
Braking Caster (brakes when seat is not occupied)	2162N
Reverse Braking Caster (brakes when seat is occupied)	2164N