

ASSEMBLY INSTRUCTIONS

FINISH ASSEMBLING CORNER RISER BY ATTACHING IT TO BOTH ADJACENT CABINET RISERS. ATTACH USING SUPPLIED 1/4-20 x 9/16" CARRIAGE SCREWS AND 1/4-20 FLANGED NUTS THAT ARE USED TO ATTACH RISER LEGS TO RISER TOP PAN.

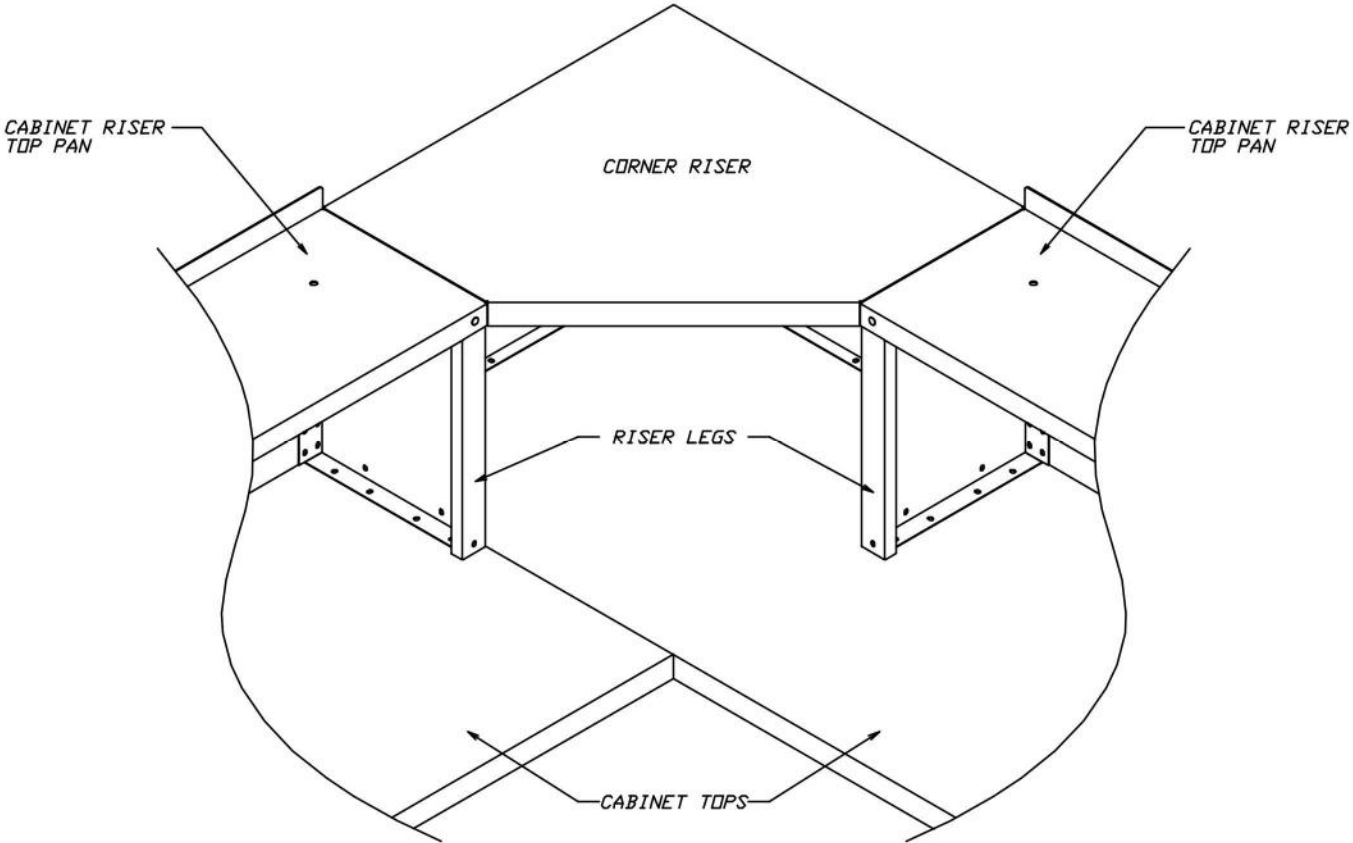
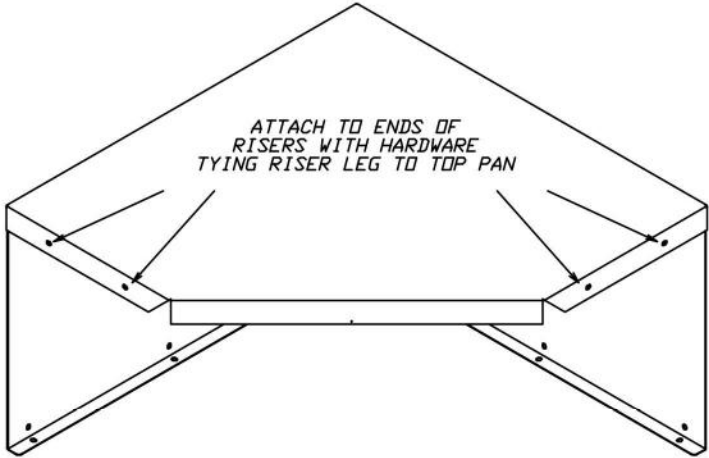

LYON P.O. Box 671
 AURORA, IL 60507-0671
 PHONE: 630-892-8941
 FAX: 800-367-6681

NOTICE: THIS IS A CONFIDENTIAL DISCLOSURE LOANED BY LYON WORKSPACE FOR REFERENCE PURPOSES ONLY

DATE 07-19-12	DRAWN BY JR	CHECKED BY DWV
------------------	----------------	-------------------

DESCRIPTION
INSTALLATION
CORNER RISER INSTALLATION
MDC

SHEET 2	DRAWING NUMBER SS1670	REV 1
------------	---------------------------------	----------

ASSEMBLY INSTRUCTIONS

ASSEMBLE CORNER SUPPORT TO TWO BACK PANELS AS SHOWN USING SUPPLIED 1/4-20 x 9/16 CARRIAGE SCREWS AND 1/4-20 FLANGED NUTS.

ATTACH TOP PAN TO BACK PANELS AS SHOWN USING SUPPLIED 1/4-20 x 9/16 CARRIAGE SCREWS AND 1/4-20 FLANGED NUTS. TOP PAN IS ATTACHED ON THE "OUTSIDE" OF THE BACK PANELS.

DRILL SIX (6) HOLES IN TOP OF CABINET TOPS AS SHOWN BELOW. 13/64" DIAMETER BY 1" DEEP HOLES FOR WOOD TOPS OR 0.221" DIAMETER HOLES FOR STEEL TOPS. ATTACH BACK PANELS TO CABINET TOPS USING EITHER SUPPLIED 1/4" LAG SCREWS AND PLAIN WASHERS FOR WOOD TOPS OR 1/4-20 x 3/4" THREAD CUTTING SCREWS AND COUNTERSUNK WASHERS FOR STEEL TOPS.

SEE REVERSE FOR FINAL INSTALLATION INSTRUCTIONS.

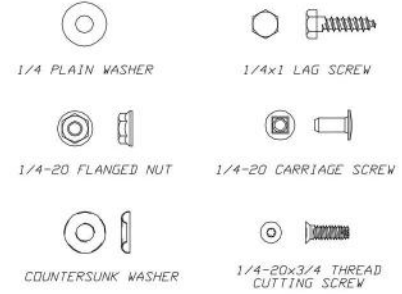

**SUPPLIED
HARDWARE**

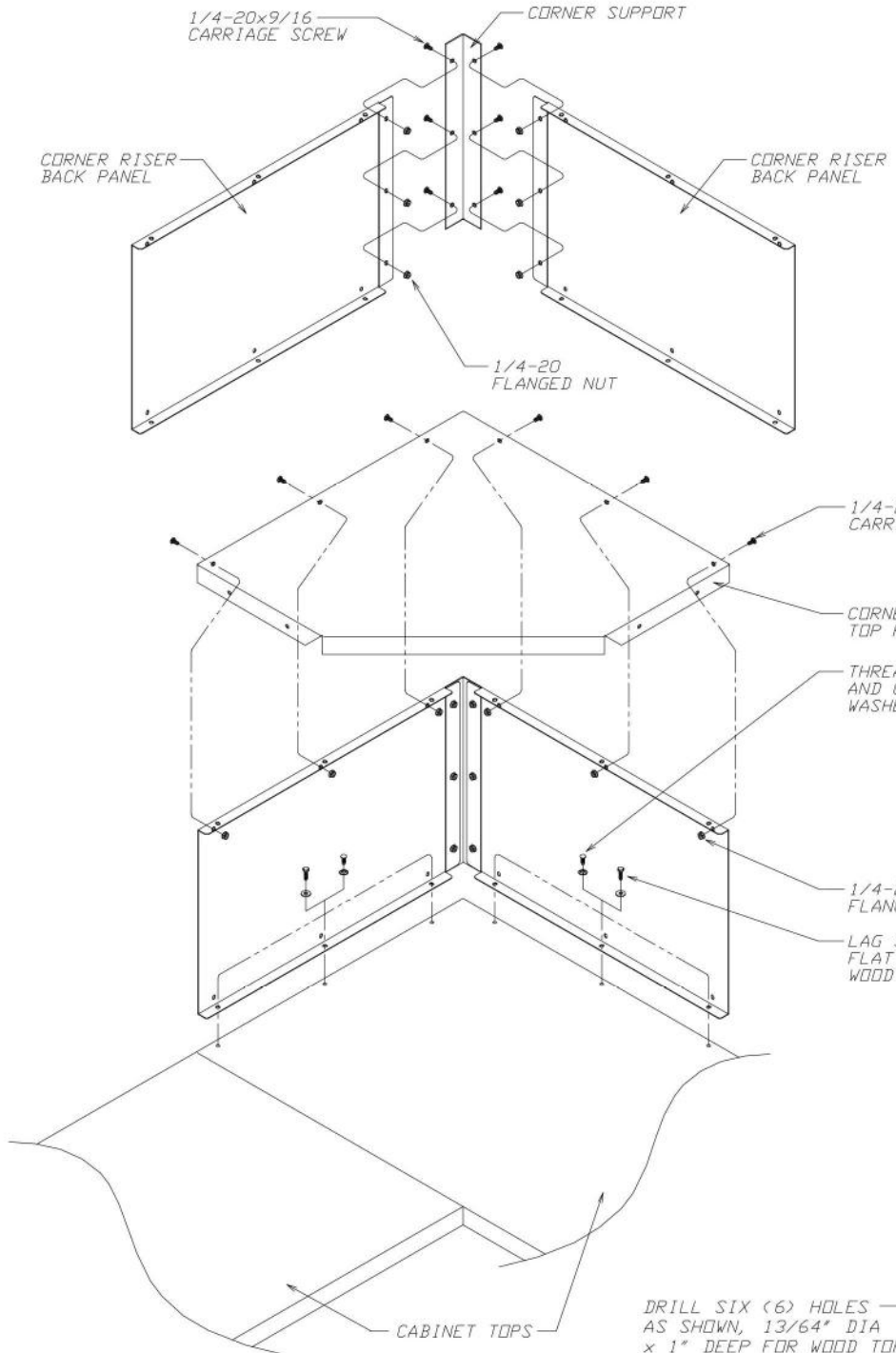

DRILL SIX (6) HOLES AS SHOWN, 13/64" DIA x 1" DEEP FOR WOOD TOP, 0.221" DIA FOR STEEL TOP

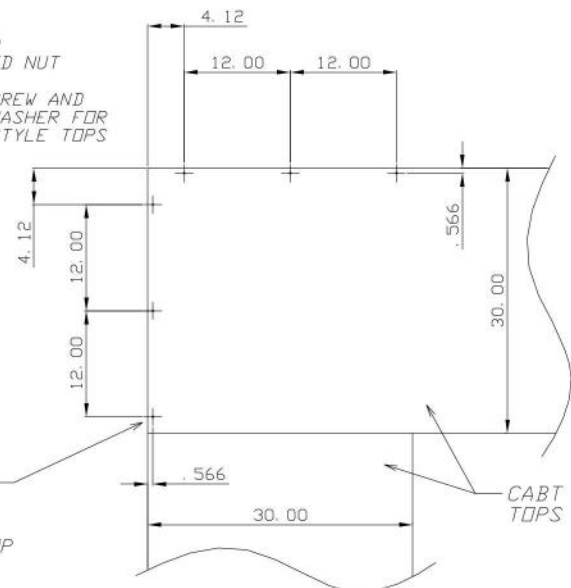

LYON P.O. Box 671
AURORA, IL 60507-0671
PHONE: 630-892-8941
FAX: 800-367-6681

NOTICE: THIS IS A CONFIDENTIAL DISCLOSURE LOANED BY LYON WORKSPACE FOR REFERENCE PURPOSES ONLY

DATE	DRAWN BY	CHECKED BY
02-04-12	JR	DWV

DESCRIPTION
**INSTALLATION
CORNER RISER
MDC**

SHEET	DRAWING NUMBER	REV
1	SS1670	1