

CLOSED BACK
7 SHELVES

CLOSED SIDE SHEET

CLOSED SIDE SHEET

CLOSED SIDE SHEET

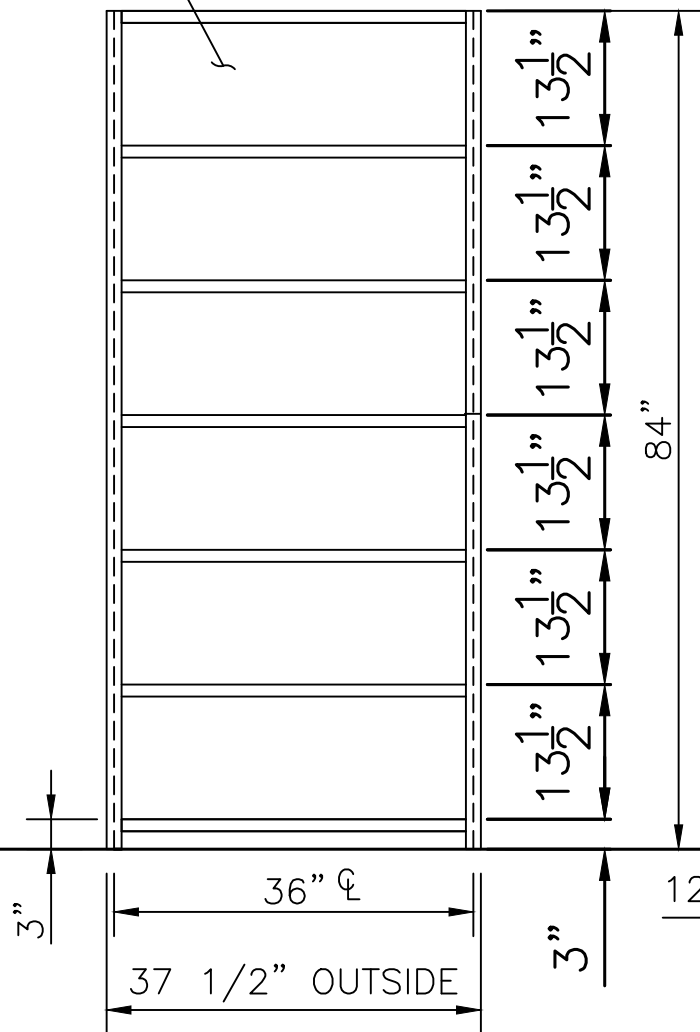

FRONT VIEW
Shelves are adjustable on
1-1/2" Centers
36" X 84"

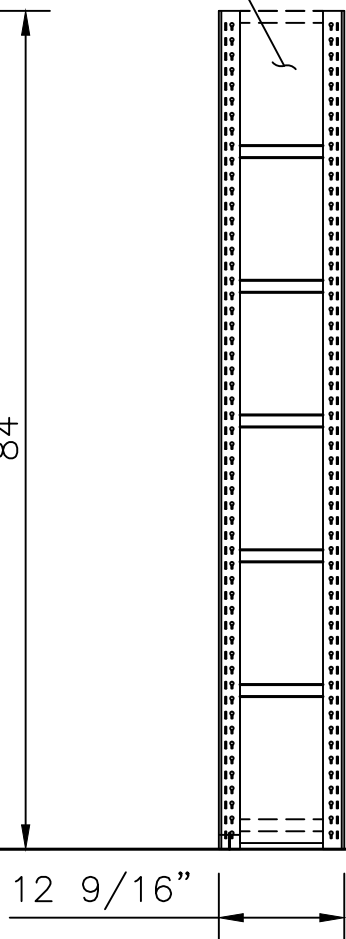

SIDE VIEW
12" X 84"

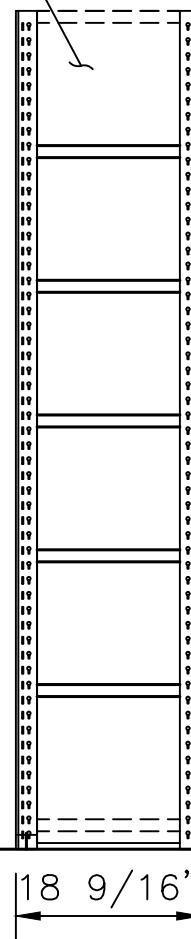

SIDE VIEW
18" X 84"

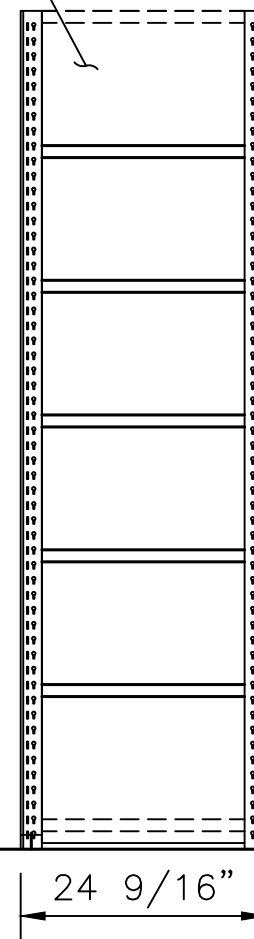

SIDE VIEW
24" X 84"