

SHELVES ADJUSTABLE
@ 3" CENTER

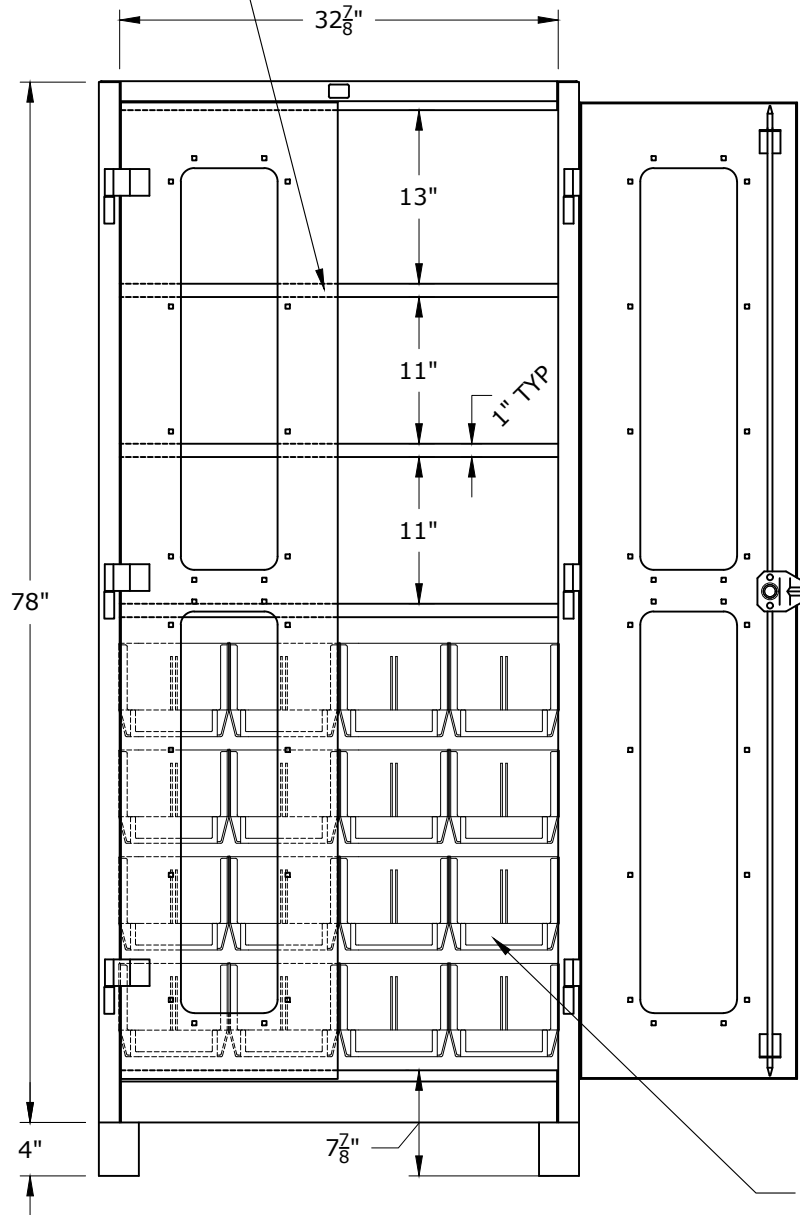

(16) LARGE REMOVABLE
PLASTIC BINS
(8-1/4"W x 14-3/4"D x 7"H)

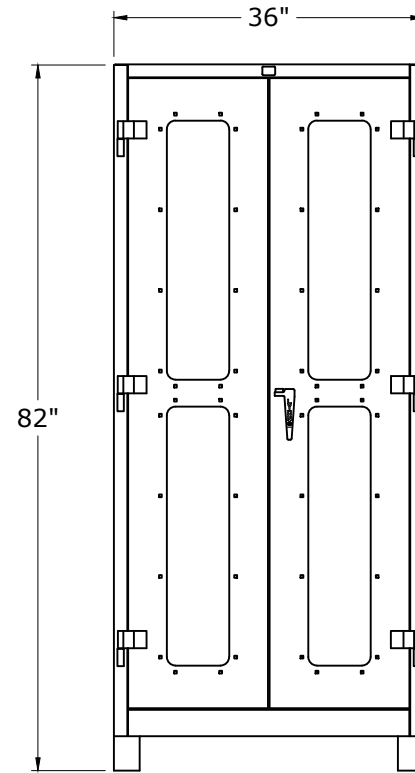

FRONT CLOSED VIEW

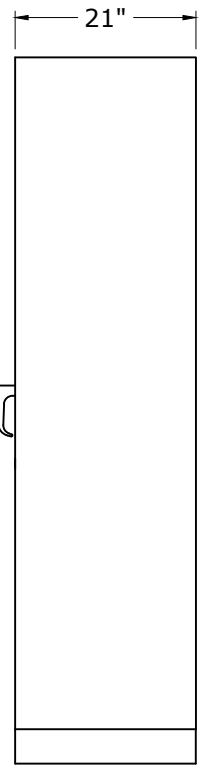

SIDE VIEW

LYON P.O. Box 671
AURORA, IL 60507-0671
PHONE: 630-892-8941
FAX: 800-367-6681

NOTICE: THIS IS A CONFIDENTIAL DISCLOSURE LOANED BY
LYON WORKSPACE FOR REFERENCE PURPOSES ONLY

DATE 08-13-12	DRAWN BY JR	CHECKED BY DWV
------------------	----------------	-------------------

DESCRIPTION

PRE-ENGINEERED CABINET
MAINTENANCE CENTER
36"W x 21"D x 82"H

SHEET	DRAWING NUMBER 1123V	REV 1
-------	-------------------------	----------