

SHELVES ADJUSTABLE  
@ 3" CENTER

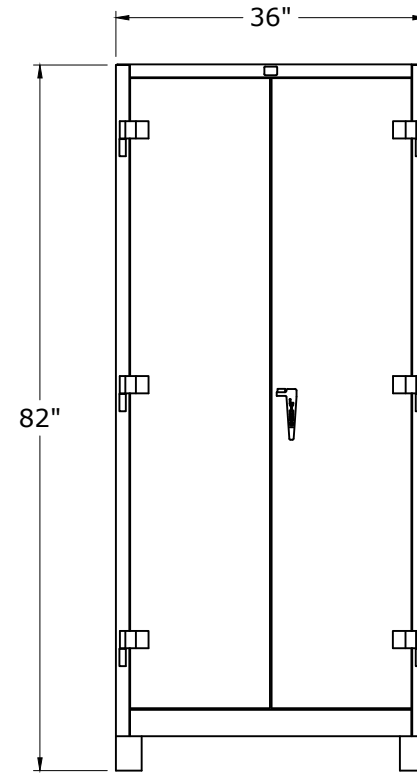

FRONT CLOSED VIEW

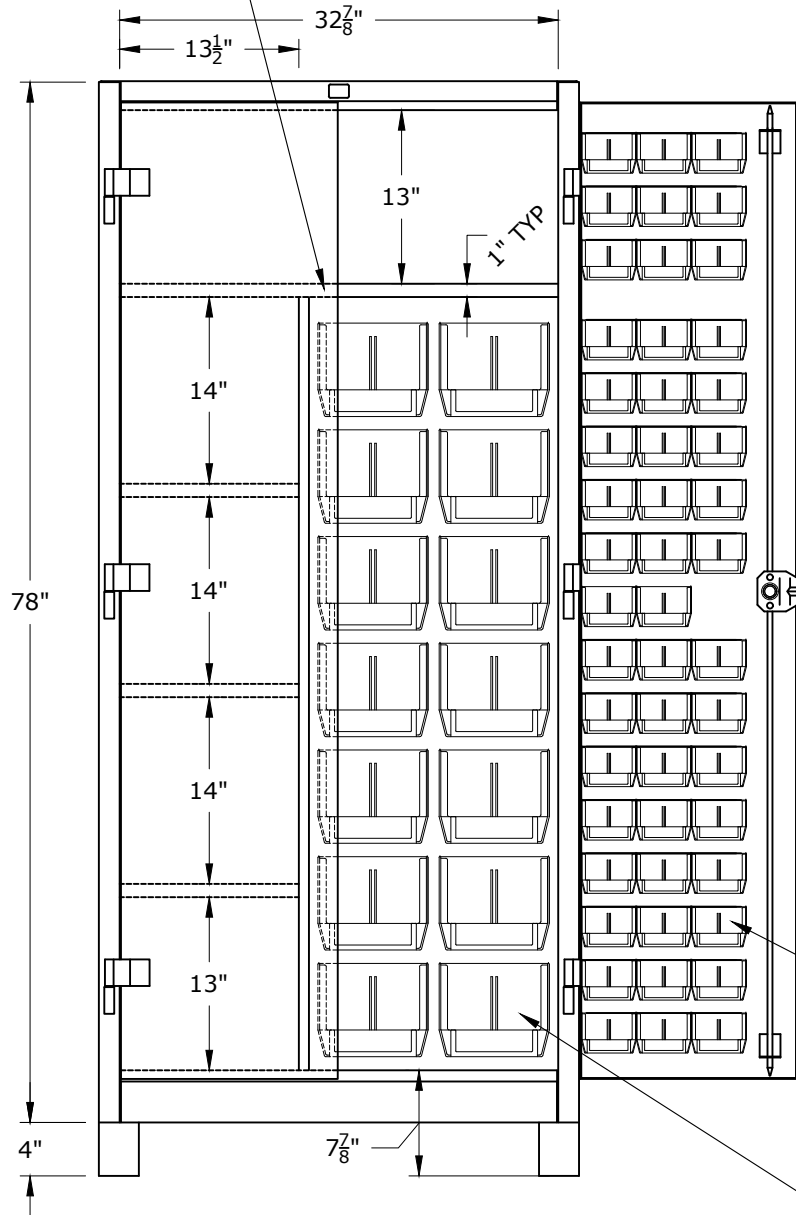
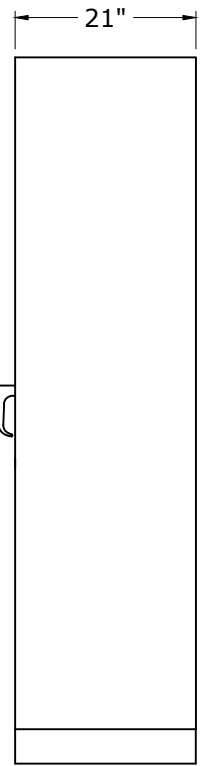

SIDE VIEW

(50) SMALL REMOVABLE  
PLASTIC BINS  
(4-1/8"W x 5-3/8"D x 3"H)

(14) LARGE REMOVABLE  
PLASTIC BINS  
(8-1/4"W x 14-3/4"D x 7"H)

**LYON**

P.O. Box 671  
AURORA, IL 60507-0671  
PHONE: 630-892-8941  
FAX: 800-367-6681

NOTICE: THIS IS A CONFIDENTIAL DISCLOSURE LOANED BY  
LYON WORKSPACE FOR REFERENCE PURPOSES ONLY

DATE 08-08-12	DRAWN BY JR	CHECKED BY DWV
------------------	----------------	-------------------

DESCRIPTION

PRE-ENGINEERED CABINET  
MAINTENANCE CENTER  
36"W x 21"D x 82"H

SHEET	DRAWING NUMBER 1122	REV 1
-------	------------------------	----------