

THE
EVOLUTION
OF THE
TECHNICIAN
WORKBENCH



EVO
SERVICE

LYON[®]

DEALERSHIP
WORKSTATIONS

THE WORKBENCH SYSTEM THAT WILL HOLD UP TO YEARS OF USE AND STILL LOOK GREAT!

- Welded steel housings for years of performance
- Textured paint hides dirt and marks and improves appearance
- Laboratory grade phenolic resin, Trespa®, door and drawer fronts resist chemicals and eliminates scratches and dents
- Modular design allows for configuration flexibility even after installation



OIL CADDY CABINETS

- Welded steel housing
- Configurable Interior
- Easy cart access

LIFT CONTROL CABINETS

- Welded steel housing
- Heavy Duty pull out slide for easy access to reservoir
- Long lasting Trespa® resin front

TOOL CARTS

- Lockable storage
- Heavy duty cart
- Door stays on cart and never blocks the walkway

TECH CENTER

- Optional technology center for up to a 17" monitor, CPU and/or tablet



PANEL SYSTEM

- Configurable panel system

UPPER CABINETS

- Welded housing
- Tip up / slide in doors
- Trespa® resin doors
- Wall mount or chase mount
- Electrical knockouts
- Under cabinet LED lighting

45° BACK STOP

- Configurable can include outlets and cable ports

BENCH TOP

- 304 stainless steel with a vibrated finish to hide marks and scratches
- Double thickness MDF Core

GARBAGE / RECYCLING CABINETS

- Welded steel housing
- Heavy duty slides

TOOL BOXES

- Welded steel housing
- Heavy duty ball bearing slides
- Recessed handles – Trespa® resin drawer fronts
- Available as single wide, double wide or combination units

HOW TO BUILD YOUR OWN WORKSTATION IN 3 EASY STEPS



- Welded steel housings for years of performance
- Textured paint hides dirt and marks and improves appearance
- Laboratory grade phenolic resin, Trespa[®], door and drawer fronts resist chemicals and eliminates scratches and dents
- Modular design allows for configuration flexibility even after installation

WORKSTATION IN 5 EASY STEPS



Oil Caddy Cabinets



Tool Boxes

Garbage
Recycling
Cabinet



Tool Carts

Lift
Control
Cabinets



HOW TO BUILD YOUR OWN WORKSTATION IN 3 EASY STEPS

**STEP
1**

Determine your space and whether you need a single or double bay. Then, begin with your base cabinets, shown above.

Common questions to ask when configuring your cabinets are:

- How much wall space or space do I have to use?
- How much tool space is needed?
- Where are utilities located?
- What type of lift control is being used?
- Will your techs use this area as a dual work station?

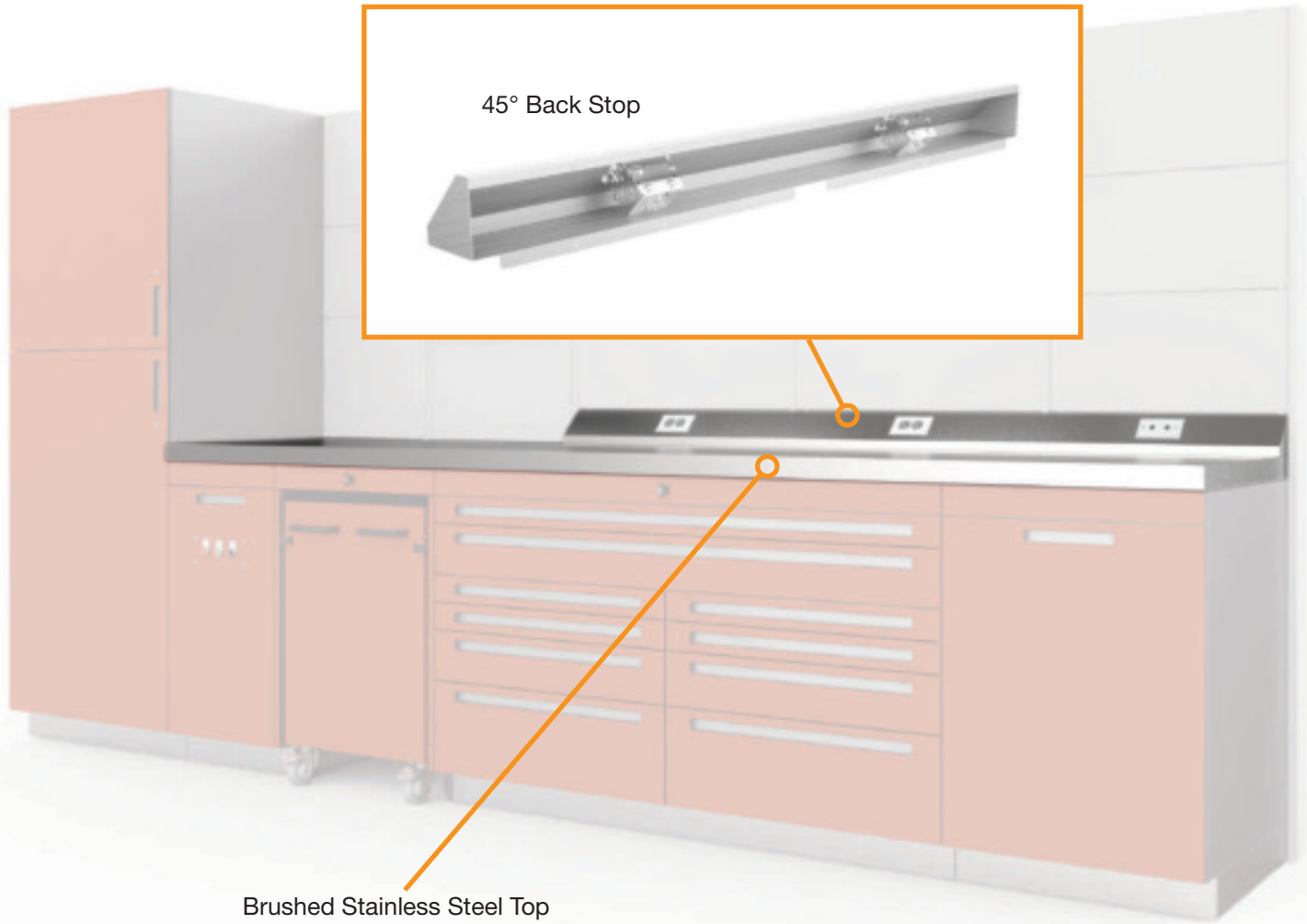

HOW TO BUILD YOUR OWN WORKSTATION IN 3 EASY STEPS

STEP 2

Choose your work surface.

Stainless steel brushed tops provide a work surface over all bases minus the Oil Caddy Cabinets. Available in the following sizes:

- 30' Deep x 60" Long
- 30' Deep x 72" Long
- 30' Deep x 96" Long
- 30' Deep x 120" Long

Stainless Steel brushed 45° Back Stop sizes:

- 30' Deep x 60" Long
- 30' Deep x 72" Long
- 30' Deep x 96" Long
- 30' Deep x 120" Long



Panel System



Upper Cabinets



Tech Center

HOW TO BUILD YOUR OWN WORKSTATION IN 3 EASY STEPS



Configure your Panel System and wall work area

Consider the following:

- Do you need electric or data inputs?
- What type of technology will you be using?
- Do you prefer tip up or slide in doors?
- Wall mount or chase mount?
- Will you require under cabinet LED lighting?



EVO
SERVICE

THE
EVOLUTION
OF THE
TECHNICIAN
WORKBENCH

FIND MORE STORAGE SOLUTIONS

LYONWORKSPACE.COM/AUTOMOTIVE-DEALERSHIP-STORAGE-SOLUTIONS



LYON[®]

PO Box 671, Aurora, IL 60507-0671

p: 800-323-0082 f: 800-367-6681

e: automotive@lyonworkspace.com

lyonworkspace.com/automotive-dealership-solutions