

SPECIALTY STORAGE

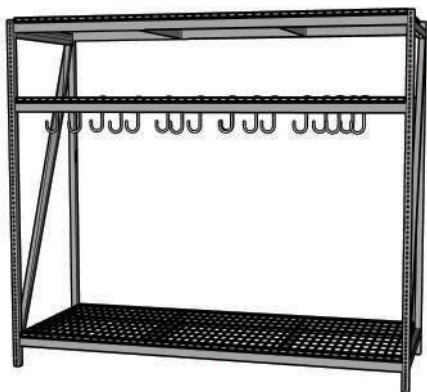

HANGING STORAGE RACK

Built from our bulk storage rack, this rack supports 1,500 lbs per level. It is ideal for storing long, odd shaped items. The included 'S' hooks easily hang from the wire decking. This rack is ideal for items like mufflers and is a good fit for an automotive dealership or parts warehouse. Available in Dove Gray.

Unit Features:

- All-Welded Uprights
- Heavy-duty Beams
- Front-to-Back Supports
- Wire Decking Panels
- 25 'S' Hooks

Width	Depth	Height	Unit
96"	36"	96"	APR5

MOLDING RACK

Built from our 2000 Series Angle Post Shelving the molding rack is ideal for storing long, fragile auto body items. Shelving units are bolted front-to-back to create a single 72" deep rack. Medium-duty shelves are used to create 10 levels within the unit. 50 sliding dividers help keep items organized within a customized space. Available in Dove Gray.

Unit Features:

- Angle Post Uprights
- Side Sway Braces and Back Brace
- 30 48"w x 24"d Medium-Duty Shelves
- 50 Sliding Dividers
- Foot Plates

Width	Depth	Height	Unit
48"	72"	85"	APR8

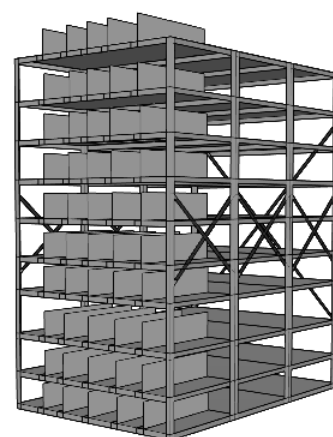

VERTICAL STORAGE RACK

Built from our rivet rack with angle post. Each level supports 800 lbs. Includes flat wire decking and either two or four vertical dividers to store items that lean on their sides. Ideal in an automotive dealership or parts warehouse to store expensive items vertically. Available in Dove Gray.

Unit Features:

- 14-gauge Angle Post Uprights
- Medium-duty Rivet Rack Beams
- Wire Decking
- Hanging Dividers

Width	Depth	Height	Dividers	Unit
72"	36"	96"	2	APR3W
			4	APR4W
72"	48"	96"	2	APR3AW
			4	APR4AW

HOOD STORAGE RACK

Built from our rivet rack with angle post. Includes either particle board or flat wire decking. Ideal in an automotive dealership or parts warehouse to store bulky items such as hoods and doors. Available in Dove Gray.

Unit Features:

- 14-gauge Angle Post Uprights
- Medium-duty Rivet Rack Beams
- Particle Board or Wire Decking

Width	Depth	Height	Capacity per Level	Decking	Unit
48"	48"	96"	1,000 lbs	Particle Board	APR6
				Wire	APR6W
48"	60"	96"	800 lbs	Particle Board	APR7
				Wire	APR7W



SPECIALTY STORAGE



TIRE RACK - WHEEL AND TIRE STORAGE

Built from our bulk storage rack, this tire rack is quick to assemble and supports 2,600 lbs per level. Easily store tires and wheels using vertical space so that it doesn't take up too much space on your shop floor. Available in Dove Gray.

Unit Features:

- 2 Ladder Brace Uprights
- 6 Heavy-duty Beams
- 3 Front-to-Back Supports
- 2 Back-to-Wall Ties
- 4 Anchoring Feet

Width	Depth	Height	Unit
60"	18"	84"	APR9C

HEAVY-DUTY GRAVITY FLOW RACK

Built from our bulk storage rack, this heavy-duty gravity flow rack is quick to assemble and supports 3,000 lbs per level. Use this rack for storing heavy automotive components and spare parts efficiently, allowing for easy retrieval and inventory management. Available in Dove Gray.

Unit Features:

- 14-gauge All-Welded Uprights
- 14-gauge Heavy-Duty Beams
- Gravity Flow Wire Decking

Width	Depth	Height	Unit
48"	36"	72"	BGF483672
		84"	BGF483684



STANDARD-DUTY GRAVITY FLOW RACK

Built from our rivet rack, this gravity flow rack is easy to assemble and supports 1,000 lbs per level. Use this rack for storing items with quick turnover rates in order picking and retail inventory. Available in Dove Gray.

Unit Features:

- 14-gauge Angle Post Uprights
- Boltless Medium-Duty Rivet Beams
- Gravity Flow Wire Decking

Width	Depth	Height	Unit
48"	36"	72"	BR483672
		84"	BR483684