

PART NUMBER OPTIONS;

**N35303010060L** = LOCKABLE SWING DOOR

**N35303010060N** = NO LOCKING SYSTEM

FEATURES;

BASE SHELF AND ADJUSTABLE SHELF BEHIND LOCKABLE SWING DOOR

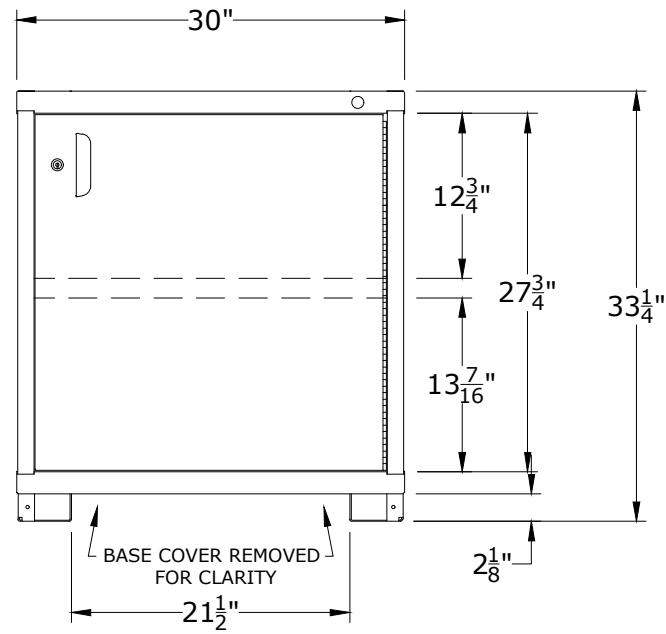

CABINET DEPTH @ 28-1/4" w/  
400lb. CAPACITY SHELVES  
EACH @ 28-1/2"W x 25"D USABLE

<b>LYON</b>		
P.O. Box 671 AURORA, IL 60507-0671 PHONE: 800-323-0082 www.lyonworkspace.com		
NOTICE: THIS DOCUMENT IS CONFIDENTIAL AND PROPRIETARY. NO PART OF THIS DOCUMENT MAY BE DISCLOSED TO A THIRD PARTY WITHOUT THE PRIOR WRITTEN CONSENT OF LYON LLC		
DATE 07/05/17	DRAWN BY JR	CHECKED BY DWV
DESCRIPTION		
PRE-ENGINEERED SHELF CABINET BENCH - STANDARD		
SHEET	DRAWING NUMBER 3530301006	REV 1