

PART NUMBER OPTIONS;

N68363010230N

FEATURES;

BASE SHELF AND TWO (2) ADJUSTABLE SHELVES

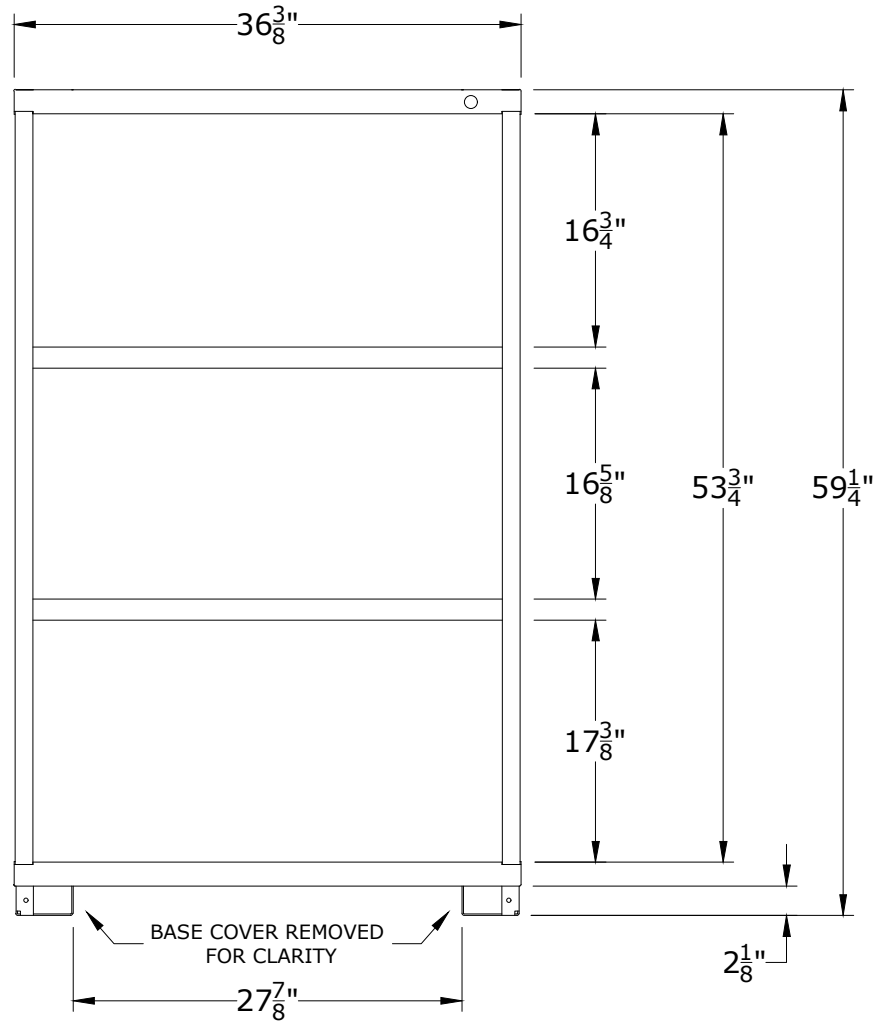

CABINET DEPTH @ 28-1/4" w/
400lb. CAPACITY SHELVES
EACH @ 34-7/8"W x 25"D USABLE

LYON P.O. Box 671
AURORA, IL 60507-0671
PHONE: 800-323-0082
www.lyonworkspace.com

NOTICE: THIS DOCUMENT IS CONFIDENTIAL AND PROPRIETARY. NO PART OF THIS DOCUMENT MAY BE DISCLOSED TO A THIRD PARTY WITHOUT THE PRIOR WRITTEN CONSENT OF LYON LLC

DATE 06/29/17	DRAWN BY JR	CHECKED BY DWV
------------------	----------------	-------------------

DESCRIPTION
**PRE-ENGINEERED
SHELF CABINET
EYE LEVEL - MEDIUM**

SHEET	DRAWING NUMBER 6836301023	REV 1
-------	------------------------------	----------