

PART NUMBER OPTIONS;

**N68453010230N**

FEATURES;

BASE SHELF AND TWO (2) ADJUSTABLE SHELVES

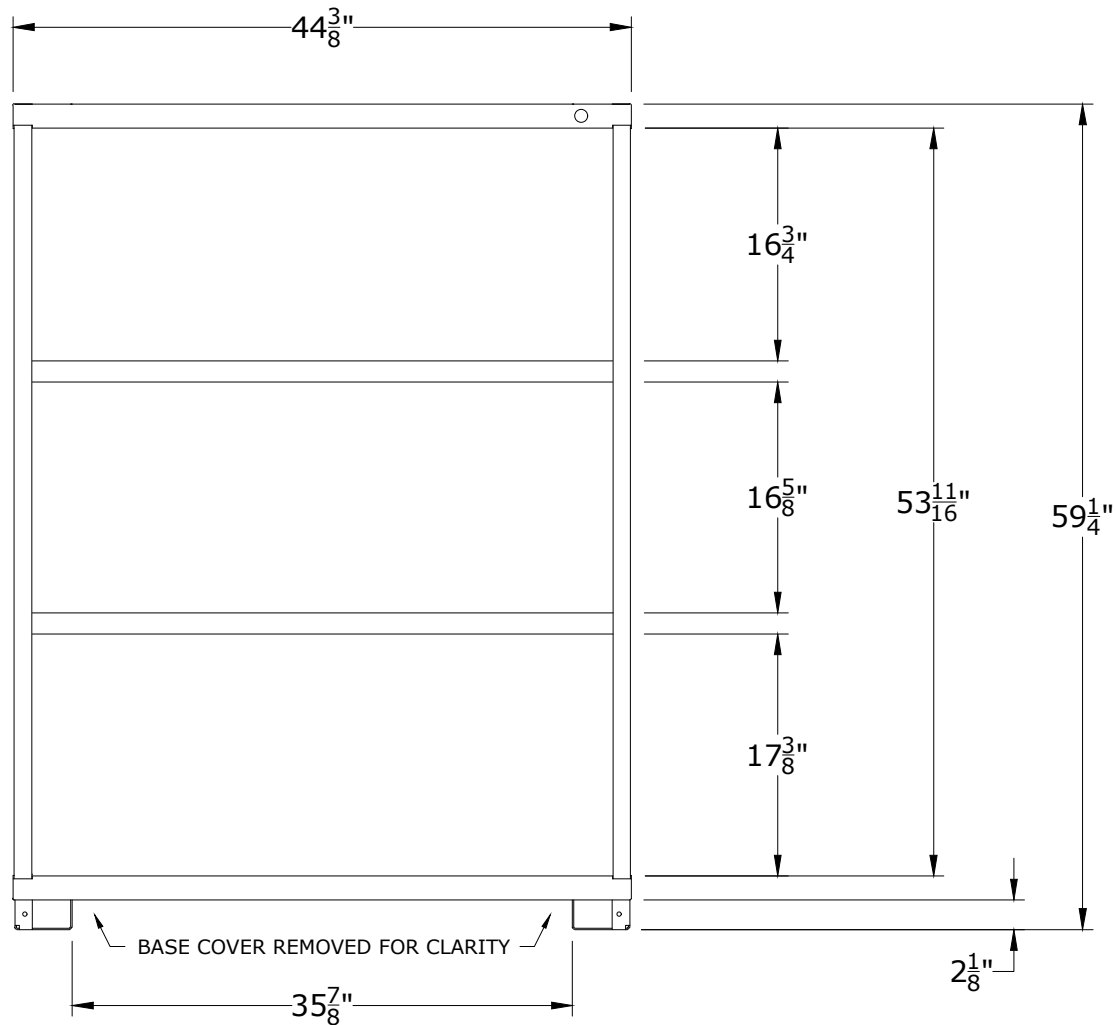

CABINET DEPTH @  $28\frac{1}{4}$ " w/  
400lb. CAPACITY SHELVES  
EACH @  $42\frac{7}{8}$ "W x 25"D USABLE

**LYON** P.O. Box 671  
AURORA, IL 60507-0671  
PHONE: 800-323-0082  
www.lyonworkspace.com

NOTICE: THIS DOCUMENT IS CONFIDENTIAL AND PROPRIETARY. NO PART OF THIS DOCUMENT MAY BE DISCLOSED TO A THIRD PARTY WITHOUT THE PRIOR WRITTEN CONSENT OF LYON LLC

DATE 06/29/17	DRAWN BY JR	CHECKED BY DWV
------------------	----------------	-------------------

DESCRIPTION

PRE-ENGINEERED  
SHELF CABINET  
EYE LEVEL - EXTRA

SHEET	DRAWING NUMBER 6845301023	REV 1
-------	------------------------------	----------