



Save This Manual For
Future Reference

OWNER'S MANUAL

LYON®

INDUSTRIAL CHAIR

MODEL NO. 2024N

DESCRIPTION

The Lyon Industrial Chair is ergonomically engineered for durability, support, comfort and long wear in tough environments. The pneumatic lift allows 8" of adjustment while you are seated and an additional 10" of manual adjustment by repositioning the lift. The footrests are polyurethane molded over steel. The five-leg base is one-piece construction of welded steel tube. The five-leg base ensures maximum stability, especially critical at high height ranges. Five high-impact, non-marking, oil-resistant glides withstand harsh environments. Casters are available as an option.

GENERAL SAFETY INSTRUCTIONS

Do not stand on seat. Chair must be on level surface to ensure proper stability. Only use chair when fully assembled. Periodically check fasteners and tighten securely as needed. Never use chair if it does not perform according to this manual. Warranty may be void if chair is used while damaged. Immediately call and report any problems (see How to Order Repair Parts) and always give the serial number from label under seat.

CAUTION: Allow for optimum support. Never position lift higher than the bottom of the base tube. Always leave at least 1/2" clearance between the bottom of the lift and the floor.

ASSEMBLY

1. Attach footrest plate (Key No. 5) onto curved tube portion of base. Align holes in footrest plate with holes in tube. Insert carriage bolts (Key No. 4) completely through plate and tube. Securely tighten with fiber hex nuts (Key No. 6). Repeat process for other footrest plate.
2. Turn base upside down. Place glide onto base leg and tap glide down (Key Nos. 1 and 2) using a rubber mallet. Glides should fit snug. Glides are easier to install if they are slightly expanded. Use blow dryer or warm water (dry thoroughly) to expand glides. Be sure glide is inserted fully onto leg to ensure stability of base. Repeat for four other glides. Turn base right side up and place on floor.
3. Insert lift assembly (Key No. 9) into base with lift piston upwards, pointed away from legs. Loosen lift adjustment handle (Key No. 7) if necessary.

4. Position lift assembly about half way down in base. Tighten lift adjustment handle to secure lift assembly. Remove yellow plastic cap from top of lift assembly. do **not** push on button at the top!
5. Install lift stop screws (Key No. 8) into threaded holes near bottom of lift assembly. Tighten screws securely.
6. Install seat on top of lift. Align hole in control assembly (Key No. 13) with top of lift. Push down on seat (Key No. 25) to insert firmly together. Underneath the seat is a handle (Key No. 11) to adjust height of lift.
7. Slide lower backstem (Key No. 18) into slot at back of control assembly. Use a standard screwdriver to depress push button near end of lower backstem. Slide backstem until push button locks in control. Remove knob with cone point (Key No. 17) from parts bag. Thread knob into control and tighten to secure lower backstem in proper position.
8. Slide upper backstem (Key No. 22) with backrest into lower backstem. Tighten knob with flat point (Key No. 19) to secure backrest in place.

MAINTENANCE

The pneumatic lift is permanently lubricated at the factory and needs no further lubrication. **Never lubricate the pneumatic lift.** This could damage the lift and void your warranty.

Do not remove clip from bottom of lift. Call for immediate assistance if clip is missing or damaged. Clean polyurethane seat and backrest with soap and water. To repair cuts, apply a few drops of quick drying glue in the cut and press the sides together until glue sets.

HOW TO ORDER REPAIR PARTS

When ordering repair parts or reporting problems, always give the following information:

| NAME OF ITEM | MODEL NUMBER |
|------------------|--------------|
| Industrial Chair | 2024N |
| PART DESCRIPTION | PART NUMBER |

All parts listed may be ordered from your local Lyon Dealer or Lyon Workspace Products, P. O. Box 671, Aurora, IL 60507
800/323-0082 or 630/892-8941

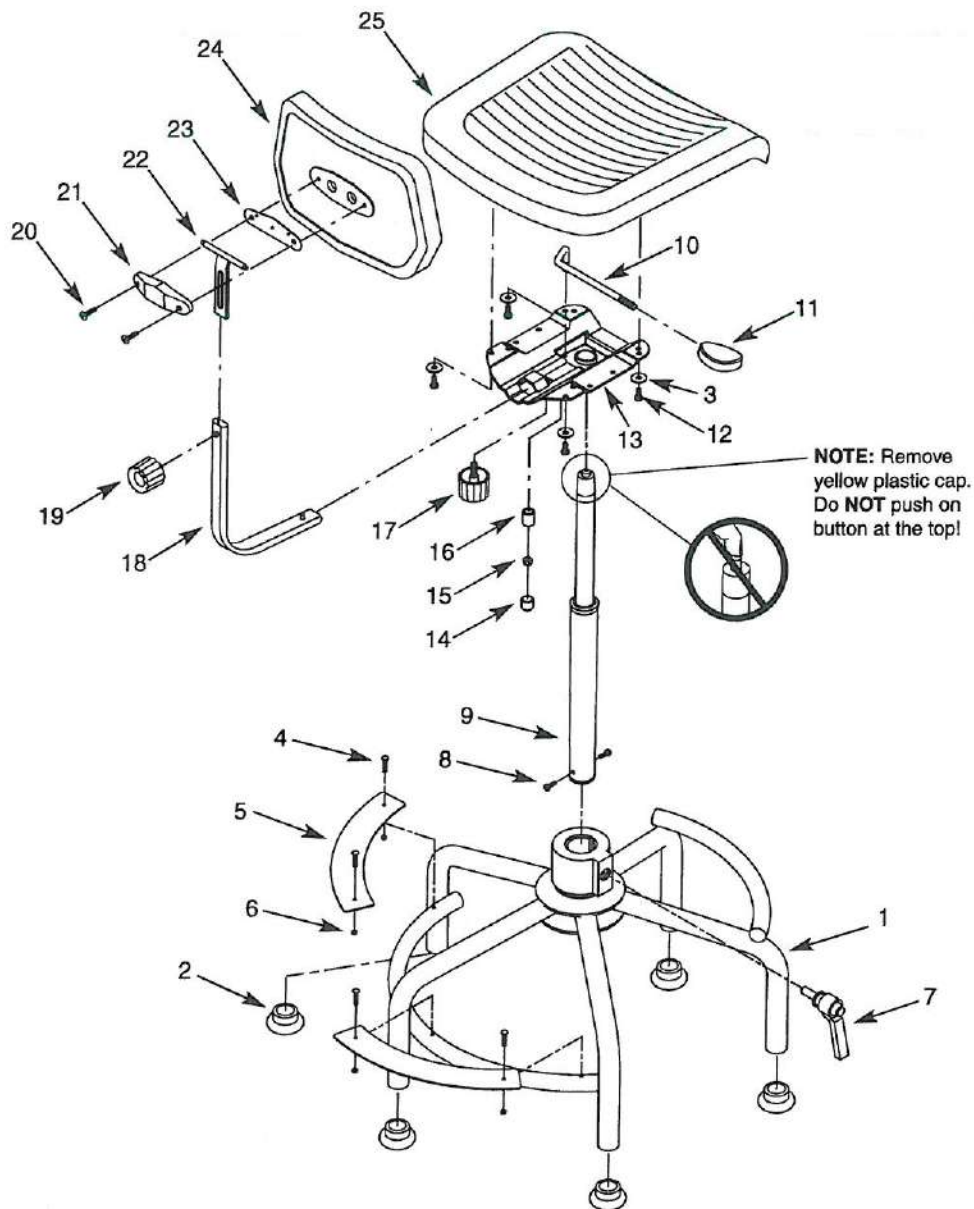

PARTS LIST

| KEY NO. | DESCRIPTION | QTY | PART NO. | KEY NO. | DESCRIPTION | QTY | PART NO. |
|---------|---|-----|----------|---------|------------------------------|-----|----------|
| 1 | Base | 1 | 01254.05 | 14 | Cap | 1 | 10196.00 |
| 2 | Glide | 5 | 09019.00 | 15 | 8-1.25mm Jam Nut | 1 | 01256.00 |
| 3 | 6mm Flat Washer | 4 | 01804.00 | 16 | Bushing | 1 | 01235.04 |
| 4 | 5/16"-18 x 1 1/2" Carriage Bolt | 4 | 10245.00 | 17 | Knob with Cone Point | 1 | 01266.02 |
| 5 | Footrest Plate | 2 | 10230.01 | 18 | Lower Backstem | 1 | 01748.02 |
| 6 | 5/16"-18 Fiber Hex Nut | 4 | 09043.00 | 19 | Knob with Flat Point | 1 | 03408.01 |
| 7 | Lift Adjustment Handle | 1 | 10244.00 | 20 | 6-1.0 x 26mm Oval Head Screw | 2 | 03714.00 |
| 8 | Lift Stop Screw | 2 | 10278.00 | 21 | Backstem Cover | 1 | 01269.02 |
| 9 | Lift Assembly | 1 | 01753.61 | 22 | Upper Backstem | 1 | 03406.02 |
| 10 | Lever | 1 | 09041.03 | 23 | Backing Plate | 1 | 03405.01 |
| 11 | Handle | 1 | 03394.02 | 24 | Backrest | 1 | 01271.06 |
| 12 | 6-1.0 x 16mm Pan Head Screw | 4 | 03713.01 | 25 | Seat | 1 | 01267.07 |
| 13 | Control Assembly (includes Key Nos. 10, 11 and 13-16) | 1 | 03247.06 | | | | |